

## Accessibility Guide for The Sandringham Estate Caravan & Motorhome Club Site

Contact for Accessibility Enquiries: Please ask for the Duty Manager

✉ sandringhamestate@camc.com

☎ 01553 631614



<https://www.caravanclub.co.uk/club-sites/england/east-anglia/norfolk/the-sandringham-estate-caravan-club-site/>

### At a Glance



#### Level Access

- The site slopes throughout, with some slopes from Toilet Block 2 being much steeper



#### Step only Access

- The play area has uneven access from the toilet block side



#### Accessible Toilets and Showers

- There is a combined accessible toilet and shower cubicle in both toilet blocks
- There is an accessible toilet cubicle in both toilet blocks



#### Accessible Pitches

- No designated accessible pitches, however pitches are allocated according to your needs or preference, so please contact us in advance to discuss your requirements.



#### We support the Hidden Disabilities Scheme

- Our organisation supports the Hidden Disabilities Scheme, lanyards and pins are available in reception

## Site Address

The Sandringham Estate Caravan Club Site  
Glucksburg Woods,  
Sandringham,  
Norfolk,  
PE35 6EZ

## Arrival and Reception

### Approach Route

- Access onto the site is via a tarmac driveway, you follow the driveway round to the left to get to the reception building
- The reception building is on the left hand side of the entry road
- The gate from the road is left open at all times but access into the site is controlled via a vehicle barrier controlled by ANPR access.
- The ground is level in this area with hard surfaced paths linking facilities.

### Parking

- A new arrival bay is set within a few metres of the Reception building
- There is space for 11 cars to park within 50 metres from Reception, including 2 Electric Vehicle charging bays and 1 marked disabled bay.
- There is a Late Night Arrival Bay on the left of the entrance driveway for 1 vehicle



## Parking

- There is a dedicated car park for the glamping units, with each unit having a sign posted space
- The parking area can be seen on the site map below
- There is a Tarmac path leading from parking to each Cabin
- The parking area is sloped throughout



## Access to Units

- The units can be accessed via smooth but sloped tarmac paths, which can be steep in some areas
- The ground here is relatively even, and there are carts to assist moving luggage



### Premium Safari Tents

- There are 4 steps up to each, with handrails to both sides, the first step is 160mm and the rest are 180mm high
- There is a large decking area, it's dimensions are 3000mm x 5200mm
- The decking has two armchairs and a coffee table



- The entrance way to the tent is a roll-up piece of canvas, which are 1200mm wide and rolls up to 1950mm high which may be difficult for some people to reach
- There is an initial 1250mm wide walk way between the kitchen and dining table upon entrance
- The kitchen counter is 940mm high, with an induction hob, sink and range of kitchen utensils
- There is a fridge with a shelf above with a microwave
- There is a full size dining table with five chairs
- There is a living room area with a sofa, a television on the wall and a log burner



- There are two bedrooms, one with a double bed and the other with a bunk bed and a single bed
- The door to the double room slides open to 430mm wide
- There is 400mm wide clear space between the double bed and the wall

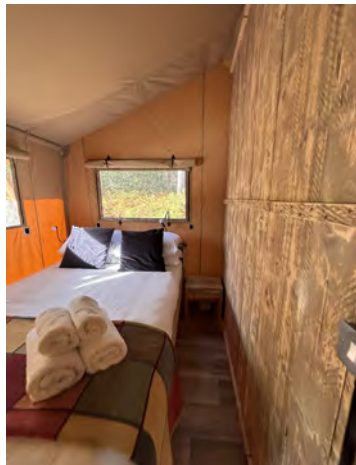

- The door to the bunk bed room slides open to 450mm wide
- There is only 300mm between the single bed and the bunk bed



## Accessibility Guide for Sandringham Estate Experience Freedom Safari Tents

- The door to the bathroom slides open to 470mm wide
- There is a standard WC
- The basin is 1020mm high
- The shower enclosure is 700mm x 1050mm with a 120mm step in

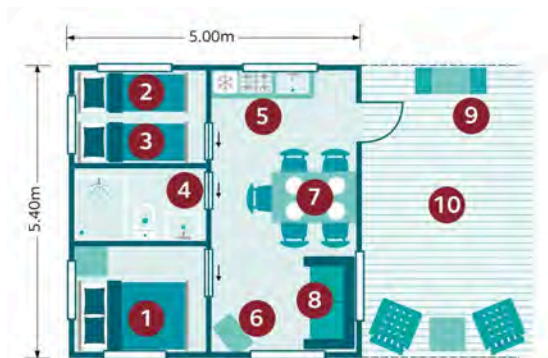

### Premium safari tent

**Key:**

- |                          |   |
|--------------------------|---|
| 1. Double bed.           | 6. TV and wood burning log stove.         |
| 2. Single bed.           | 7. Dining table.                          |
| 3. Bunk beds.            | 8. Sofa.                                  |
| 4. En-suite with shower. | 9. Boot box.                              |
| 5. Kitchen area.         | 10. Veranda with coffee table and chairs. |

Accommodation may vary slightly per location.

## Floorplan of the Premium Safari Tents

### Deluxe Safari Tents

- There are 4 steps up to each, with handrails to both sides, the first step is 160mm and the rest are 180mm high or a 1200mm wide ramp to access
- There is a large decking area, it's dimensions are 3000mm x 5200mm
- The decking has two armchairs, a sofa and a coffee table



- The entrance way to the tent is a roll-up piece of canvas, which is 1400mm wide and rolls up to 1950mm high which may be difficult for some people to reach
- There is an initial 1250mm wide walk way between the kitchen and dining table upon entrance
- The kitchen counter is 940mm high, with an induction hob, sink and range of kitchen utensils and a dishwasher below
- There is a fridge freezer with a shelf above with a microwave
- There is a full size dining table with chairs on one side and a bench on the other
- There is a living room area with a sofa, a television on the wall and a log burner



- There is a central corridor to the bedrooms and the bathroom, which is 700mm wide at it's narrowest point
- There are three bedrooms, one with a double bed, a cupboard style bed with two single beds next to each other and the other with a bunk bed
- The door to the double room slides open to 660mm wide
- There is 420mm wide clear space between the double bed and the wall



- The door to the bunk bed room slides open to 680mm wide
- There is 800mm x 1750mm clear space next to the bunk bed



- The cupboard bedroom is accessed via a ladder, the door is 1300mm high
- The cupboard bedroom has a 750mm x 750mm door



- The door to the bathroom slides open to 660mm wide
- There is 460mm between the basin and shower to access the WC
- There is a standard WC
- The shower enclosure is 700mm x 1050mm with a 120mm step in
- The basin is 1020mm high

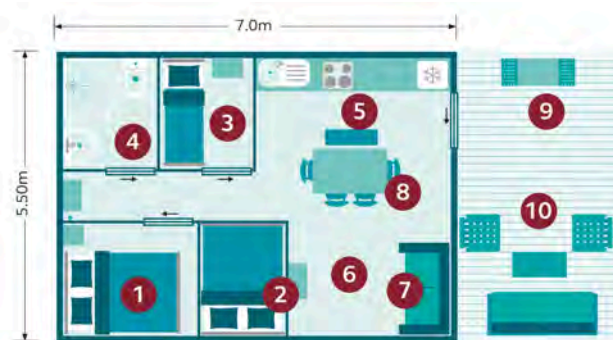

## Deluxe safari tent

### Key:

- |                             |   |
|-----------------------------|---|
| 1. Double bed.              | 6. TV and log burner.                     |
| 2. Raised double cabin bed. | 7. Sofa.                                  |
| 3. Bunk bed.                | 8. Dining table.                          |
| 4. En-suite with shower.    | 9. Boot box.                              |
| 5. Kitchen area.            | 10. Veranda with coffee table and chairs. |

Accommodation may vary slightly per location.

## Floorplan of the Deluxe Safari Tents

### Large Deluxe Safari Tents

- There are 4 steps up to each, with handrails to both sides, the first step is 160mm and the rest are 180mm high or a 1200mm wide ramp to access
- There is a large decking area, it's dimensions are 3000mm x 5200mm
- The decking has two armchairs, a sofa and a coffee table



- The entrance way to the tent is a roll-up piece of canvas, which are 1400mm wide and rolls up to 1950mm high which may be difficult for some people to reach
- There is an initial 1250mm wide walk way between the kitchen and dining table upon entrance
- The kitchen counter is 940mm high, with an induction hob, sink and range of kitchen utensils and a dishwasher below
- There is a fridge freezer with a shelf above with a microwave
- There is a full size dining table with chairs on one side and a bench on the other
- There is a living room area with a sofa, a television on the wall and a log burner



- There is a central corridor to the bedrooms and the bathroom, which is 750mm wide at it's narrowest point
- There are three bedrooms, one with a double bed, a cupboard style bed with two single beds next to each other and the other with two bunk beds
- The door to the double room slides open to 670mm wide
- There is 500mm wide clear space between the double bed and the wall and 670mm clear space at the foot of the bed



- The door to the bunk bed room slides open to 600mm wide
- There is 600mm clear space between the bunk beds



- The cupboard bedroom is accessed via a ladder, the door is 1300mm high
- The cupboard bedroom has a 750mm x 750mm door



- The door to the bathroom slides open to 660mm wide
- There is 460mm between the basin and shower to access the WC
- There is a standard WC
- The shower enclosure is 700mm x 1050mm with a 120mm step in
- The basin is 1020mm high

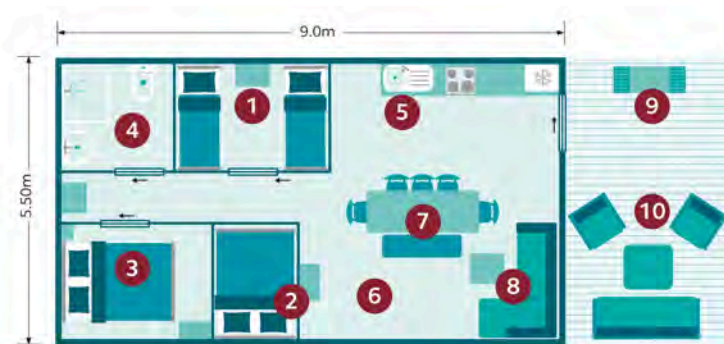

### Large deluxe safari tent

**Key:**

- 1. Two sets of bunk beds.
- 2. Raised double cabin bed.
- 3. Double bed.
- 4. En-suite with shower.
- 5. Kitchen area.
- 6. TV and log burner.
- 7. Dining table.
- 8. Sofa.
- 9. Boot box.
- 10. Veranda with coffee table and chairs.

Accommodation may vary slightly per location.

## Floorplan of the Large Deluxe Safari Tents

### Accessible Safari Tents

- There is a 1200mm wide ramp at a 1:17 gradient to the decking
- The gate opens to 950mm wide, and opens into the decking with a 1000mm high latch
- There is a large decking area, with an 1800mm x 2400mm turning circle
- The decking has an armchair, a sofa and a coffee table and a plastic dining table and chairs



- The entrance way to the tent is a roll-up piece of canvas, which are 1400mm wide and rolls up to 1950mm high which may be difficult for some people to reach
- There is an initial 1250mm wide walk way between the kitchen and dining table upon entrance
- The kitchen counter is at two heights, there are two sections at 930mm high with a kitchen cupboard below and a dishwasher below. There is also a dropped section at 850mm high with 750mm knee space below
- The dropped section has an induction hob and a sink
- There is a fridge freezer
- There is a safety kettle on the kitchen counter and a microwave on the counter
- The crockery is kept on a shelf at the back of the counter, if you need some of these moved to a lower surface please ask site staff

- There is a full size dining table with chairs on one side and a bench on the other
- There is a living room area with a sofa, a television on the wall and a log burner
- There is 800mm between the edge of the table and the corner of the fireplace surround



- There is a central corridor to the bedrooms and the bathroom, which is 900mm wide at it's narrowest point



- There are three bedrooms, one with a double bed, one with a single bed and one with two motor powered twin beds
- The door to the double room slides open to 680mm wide
- There is 650mm wide clear space at the foot of the bed and only 100mm between the corner of the bed and the corner of the wardrobe



- The door to the single room slides open to 670mm wide
- There is 650mm clear space to the side of the bed



- The accessible bedroom with the electric motorised beds has a door that slides to 970mm wide
- There is 900mm clear space at the foot of the beds
- There is 800mm clear space between the beds



- The bathroom is accessed through the accessible bedroom
- The door to the bathroom slides to 900mm wide
- The bathroom is a wet room style bathroom, with a shower, basin and WC with grab rails at all of these
- There is a standard WC at 500mm high with transfer from both sides, there is 1050mm clear space from the left and 750mm clear space from the right
- The shower seat is 500mm high with left hand transfer
- The shower controls are 1000mm high, the shower is on a sliding rail between 1300mm and 1800mm high
- There is an emergency pull cord alarm next to the WC



